

H350GUR

3.5" Non-IC Air-Tight Incandescent Remodel Housing (120V MR16, LED)

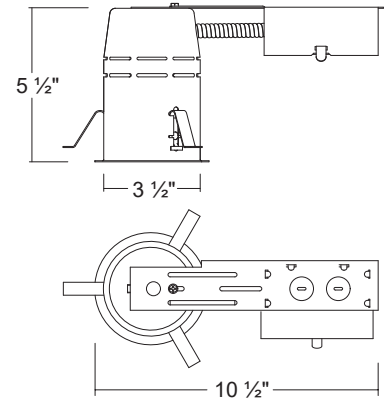

Dimensions



ORDERING INFORMATION

Model No.	Description
H350GUR	3.5" Non-IC Air-Tight Incandescent Remodel Housing (120V MR16, LED)

SPECIFICATION

Junction Box

- Listed for through branch circuit wiring
- Contains one 1-1/8", six 7/8" knockouts and four Romex pryouts with strain relief

Remodel Clips

- Three Remodel clips secure housing and accommodates 1/2" and 5/8" ceiling materials.

Thermal Protector

- Self resetting thermal protector deactivates fixture if overheating occurs due to improper lamping or misapplied insulation.

Lamps

- 120V GU10 MR16 Max. 50W, GU10 LED

Listings

- cULus Listed for Damp Location
- cULus Listed for Feed Through